

# INSTRUCTION SHEET

## PROXIMITY SERIES

### MOUNTING PLATE

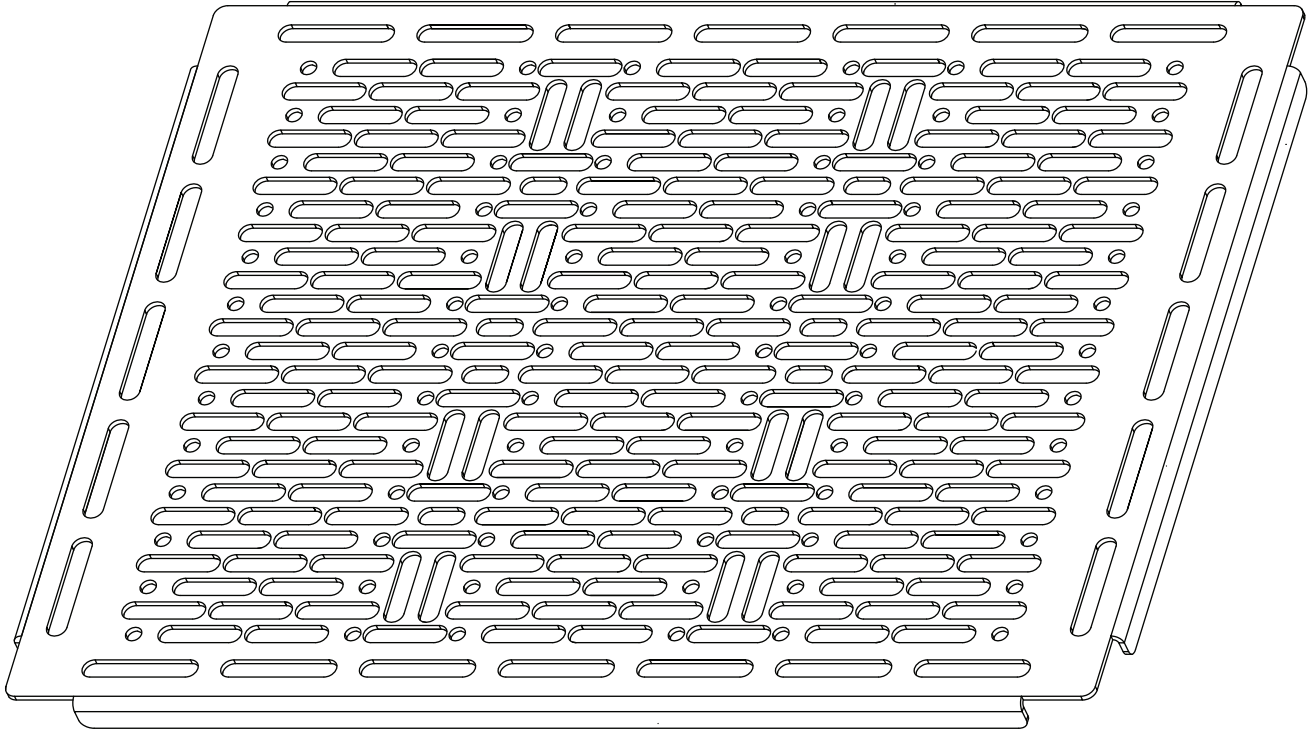

#### THANK YOU

Thank you for purchasing the Proximity Series Mounting Plate. Please read these instructions thoroughly before installing or assembling this product.

#### PRODUCT FEATURES

- The Mounting Plate (PRX-MP-9x12) provides mounting of AV components and power that can be conveniently hidden behind a wall-mounted display.
- The plate is mounted via VESA to the back of the display.

## SUPPLIED COMPONENTS AND HARDWARE

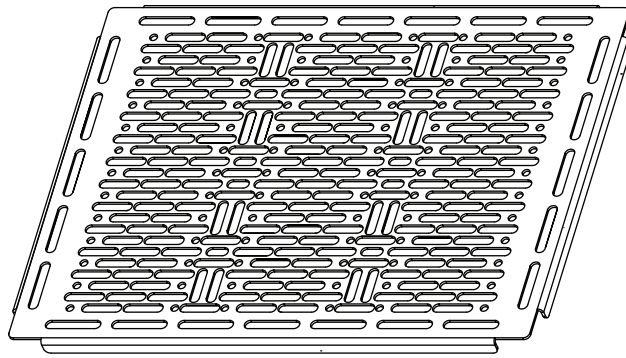

Mounting Plate

A

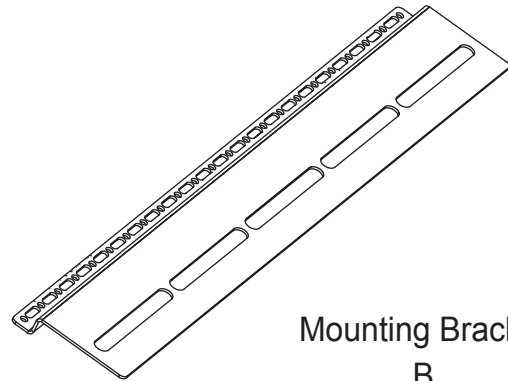

Mounting Bracket

B



(2x) Thumb Screw

C



(4x) Thumb Nut

D



PEM Stud

E



Flange Nut

F



(3x) Thread  
Forming Screw

G



(20x) Component  
Mounting Washer

H

## REQUIRED TOOLS

- No. 2 Phillips Driver
- 1/2" Socket or Nut Driver
- Wire cutter

## WEIGHT RATINGS

Model	Weight Rating
PRX-MP-9x12	10 lbs. Maximum Total Rated Load

**WARNING:** This plate is intended for use only with the products and maximum weights indicated. Use with other products or products heavier than the maximum weights indicated may result in instability causing possible injury. Total equipment weight must not exceed 10 lbs. (4.53 kg).

**AVERTISSEMENT:** Cette plaque est conçue pour être utilisée uniquement avec les produits et les poids maximum indiqués. uniquement avec les produits et les poids maximaux indiqués. En cas d'utilisation avec d'autres produits ou des produits plus lourds que le poids maximal indiqué, le chariot peut devenir instable et causer des blessures. Le poids total de l'équipement ne doit pas dépasser 4.53 kg (10 lbs).

## INSTALLING THE MOUNTING BRACKET TO VESA HOLES

**NOTE:** The mounting bracket (B) may be installed using VESA holes between display mount brackets and the monitor in vertical or horizontal positions as shown. (**FIGURE A**)

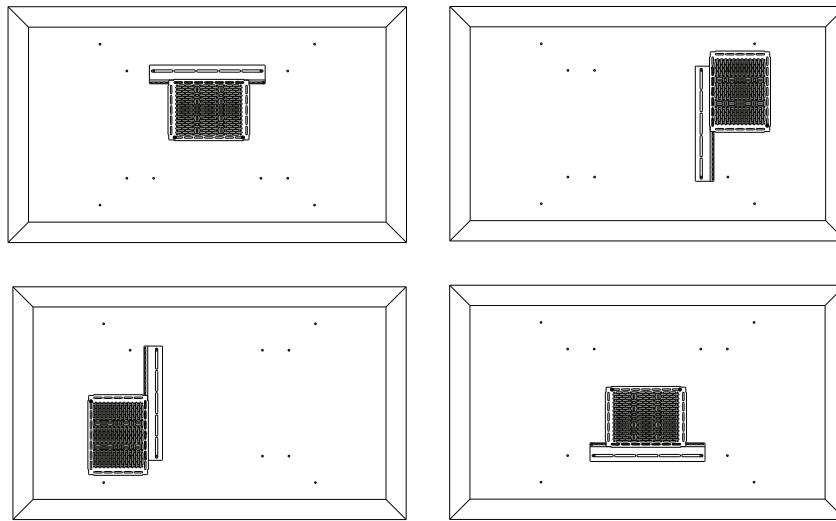
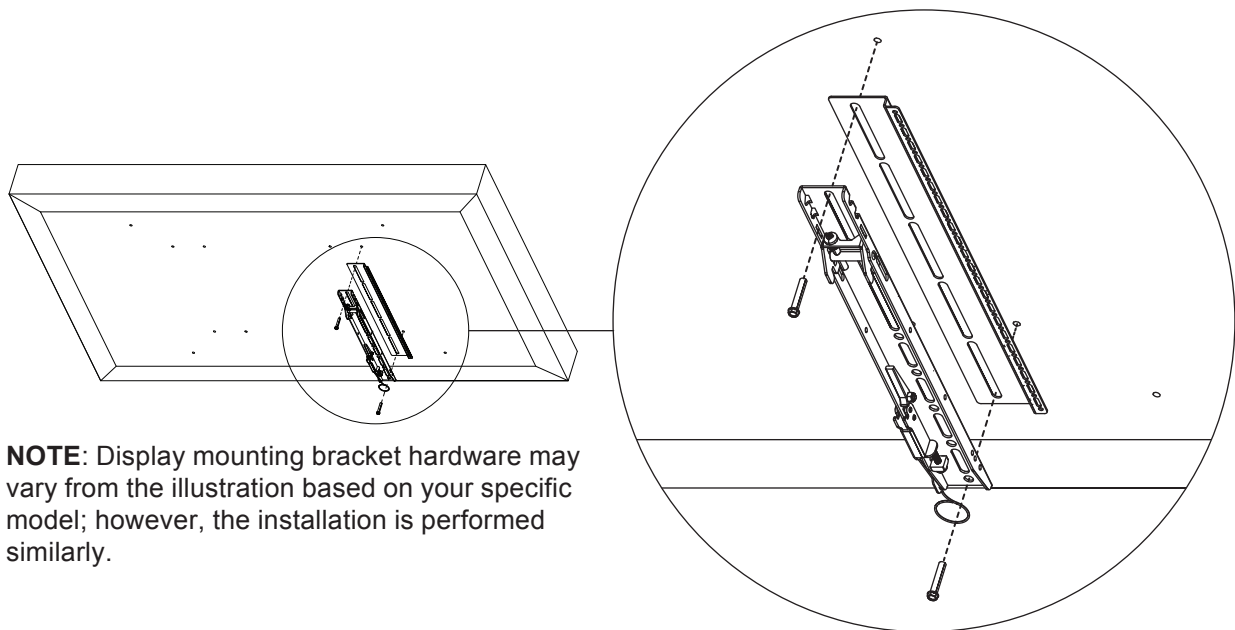

**FIGURE A**

1. Carefully place your display face down on a soft surface.

**NOTE:** If display mounting bracket hardware is already installed on the back of your display and you plan to install your bracket to VESA holes, the hardware will have to be removed to install the mounting bracket.

2. Use the hardware provided with your display mount brackets to attach the mounting bracket (B) between the display mounting bracket and the back of the monitor as shown. (**FIGURE B**)



**NOTE:** Display mounting bracket hardware may vary from the illustration based on your specific model; however, the installation is performed similarly.

**FIGURE B**

## INSTALLING THE MOUNTING BRACKET TO THE DISPLAY MOUNTING BRACKET

**NOTE:** Instead of attaching the mounting bracket (B) to VESA holes, you may also attach it directly to the display mounting bracket, if desired.

1. Carefully place your display face down on a soft surface.
2. Use a PEM stud (E) and flange nut (F) to attach the mounting bracket (B) to your desired points on the display mounting bracket. **(FIGURE C)**

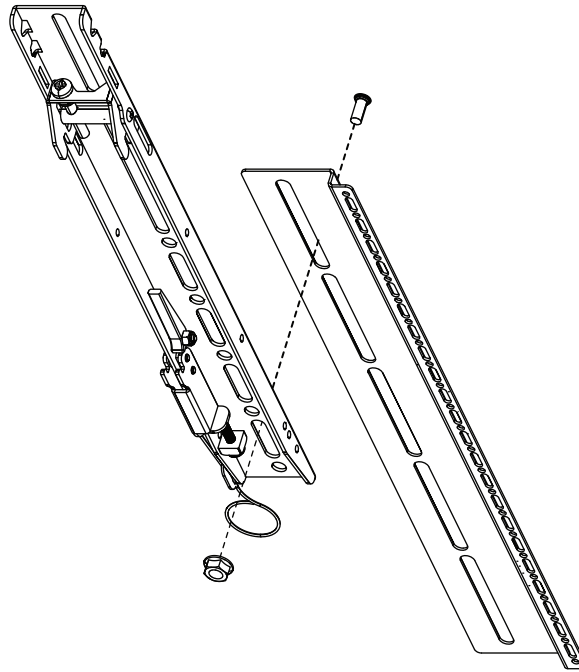

**FIGURE C**

## INSTALLING THE THUMB SCREWS AND NUTS

1. Attach (2x) thumb screws (C) to (2x) thumb nuts (D) through corners on the mounting plate (A) as shown. **(FIGURE D)**

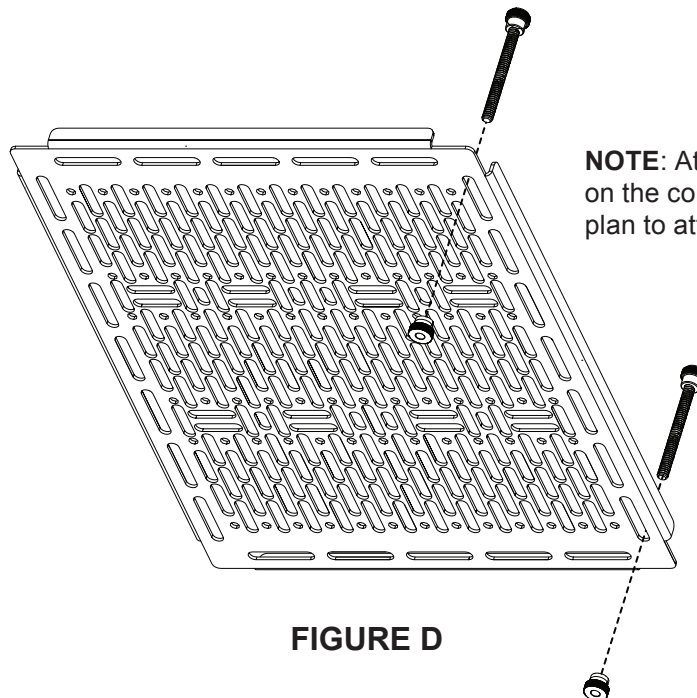

**NOTE:** Attach the thumb screws and nuts on the corners of the opposite side you plan to attach to the mounting bracket.

**FIGURE D**

## ATTACHING A DEVICE

1. Lay device(s) on mounting plate (A). Position device in desired location with hole pattern in plate that best aligns device mounting holes. Using mounting hardware provided by your device manufacturer and supplied mounting washers (H), secure your device to mounting plate. (**FIGURE E**)

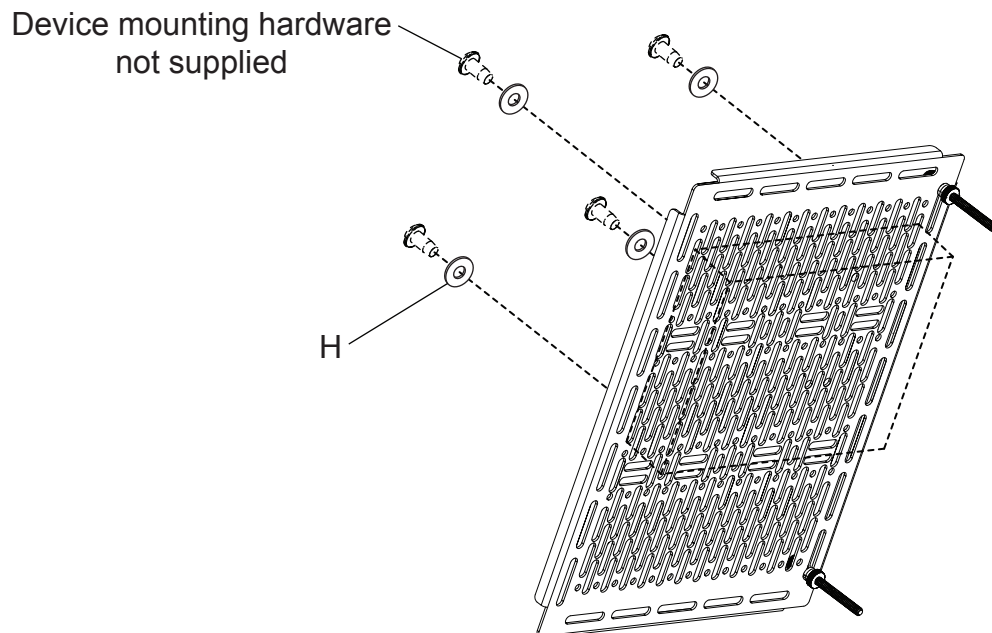

**FIGURE E**

## ATTACHING THE MOUNTING PLATE TO THE BRACKET

1. Use (2x) 10-32 thread forming screws (G) to attach the mounting plate (A) to the mounting bracket (B) as shown. (**FIGURE F**)

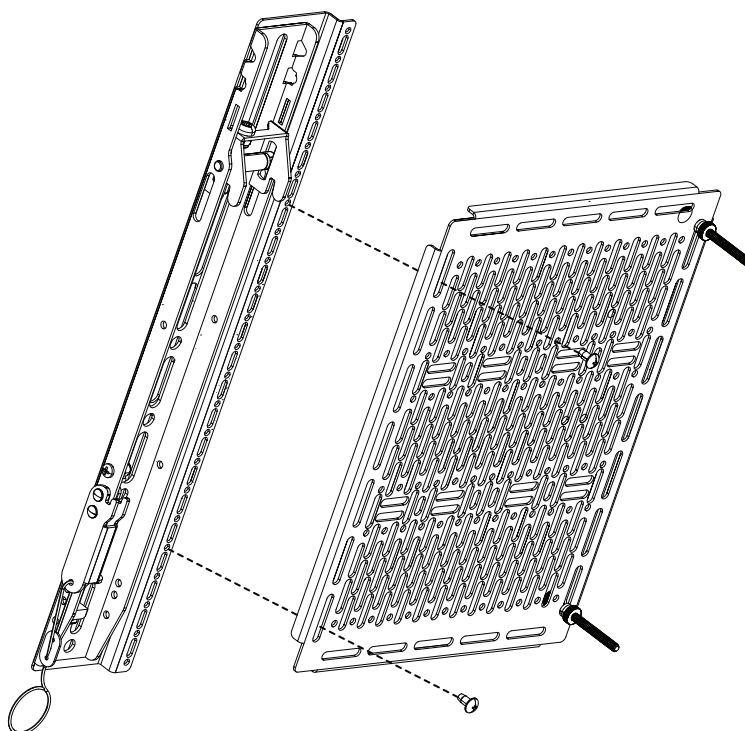

**FIGURE F**

## ADJUSTING AND TRIMMING THE THUMB SCREWS

1. Loosen the (2x) thumb screws (C) from the (2x) thumb nuts (D) until the mounting plate (A) is parallel to the back of the display. **(FIGURE G)**
2. Use a wire cutter to trim off any remaining excess portion of the (2x) thumb screws (C). **(FIGURE G)**

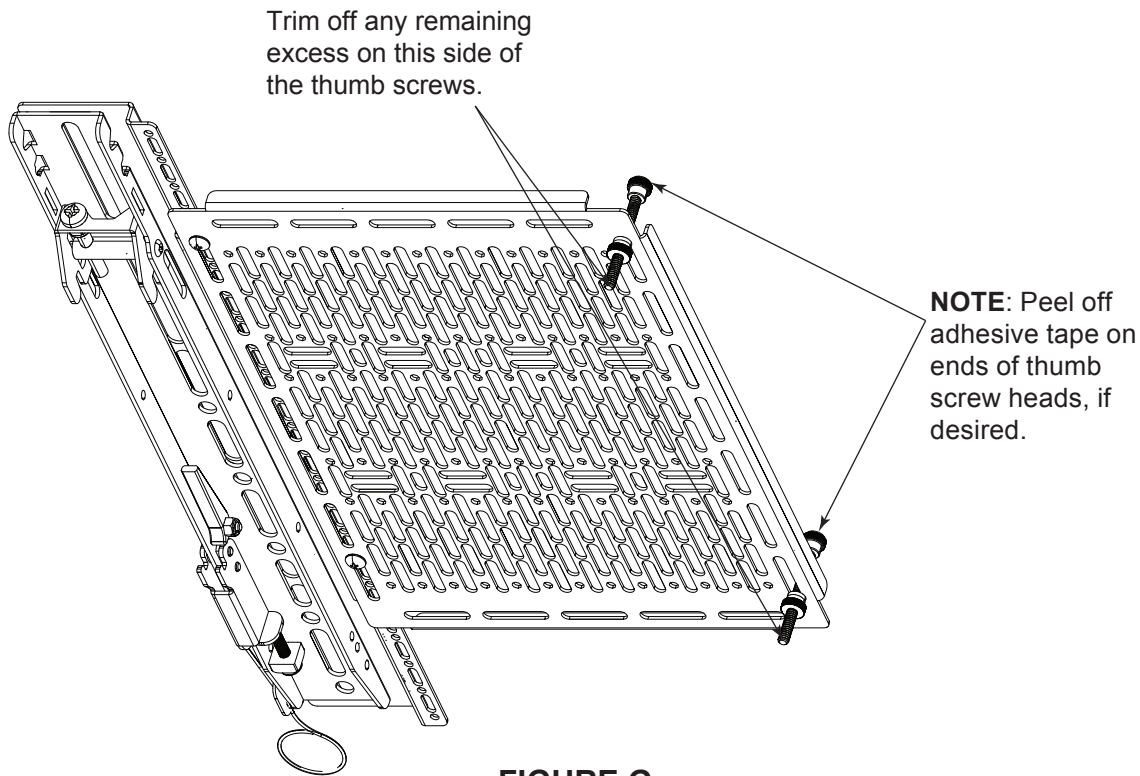

**FIGURE G**

## WARRANTY

For warranty information, refer to [www.middleatlantic.com/terms](http://www.middleatlantic.com/terms).

### Corporate Headquarters

Corporate Voice: 973-839-1011 - Fax: 973-839-1976 / International Voice: +1 973-839-8821

Fax: +1 973-839-4982

[www.middleatlantic.com](http://www.middleatlantic.com) - [info@middleatlantic.com](mailto:info@middleatlantic.com)

### Middle Atlantic Canada

Voice: 613-836-2501 - Fax: 613-836-2690 / [ca.middleatlantic.com](http://ca.middleatlantic.com) -

[customerservicecanada@middleatlantic.ca](mailto:customerservicecanada@middleatlantic.ca)

### Factory Distribution

USA: NJ - CA - IL Canada: ON - BC

**At Middle Atlantic Products we are always listening. Your comments are welcome.**

**Middle Atlantic Products is an ISO 9001 and ISO 14001 Registered Company.**